

SYMBOL LS2208

Quick Start Guide

<http://www.symbol.com/ls2208>

POST IN WORK AREA

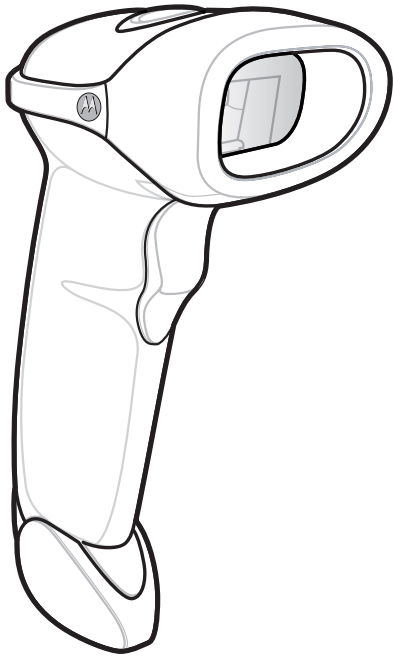

See Product Reference Guide for more information

Miscellaneous Settings

Set Defaults



SET DEFAULTS

Carriage Return/Line Feed



SCAN OPTIONS



<DATA><SUFFIX>



ENTER

NOTE: Cables may vary depending on configuration.

Step 1 - Cord Attachment/Removal

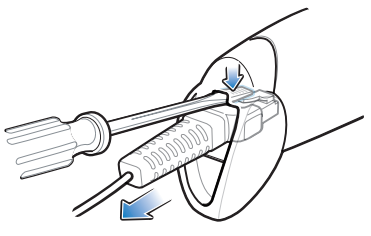
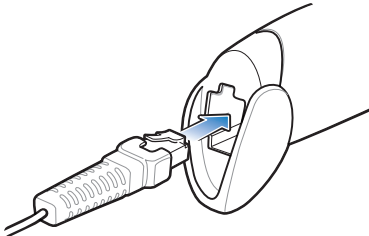

Step 2 - Connect to Host

RS-232

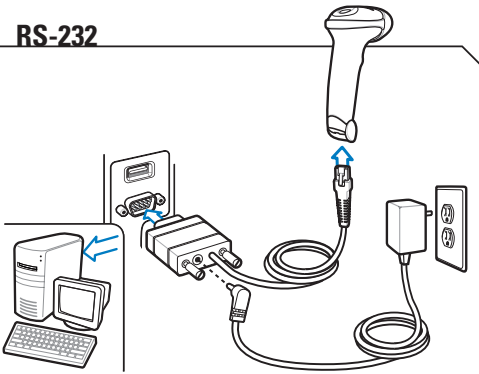

USB

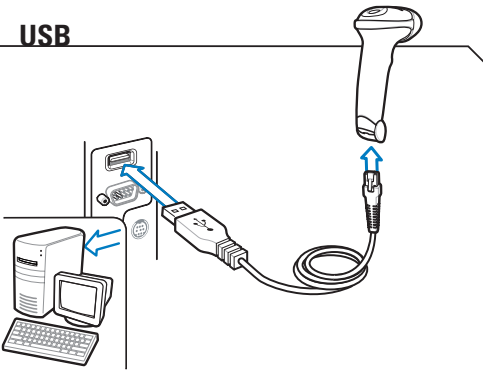

IBM 46XX

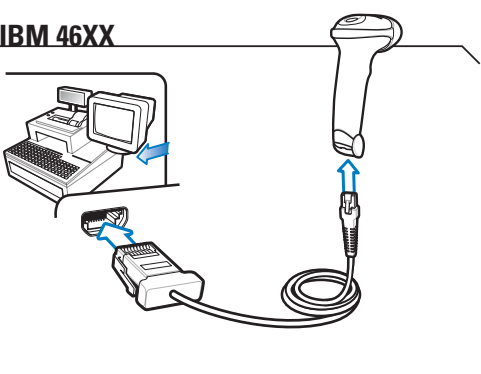

Step 3 - Scan **ONE** of the following



STANDARD RS-232



ICL RS-232



NIXDORF RS-232 MODE A



NIXDORF RS-232 MODE B



FUJITSU RS-232



OPOS/JPOS



HID KEYBOARD EMULATION



IBM HAND-HELD USB

Keyboard Wedge

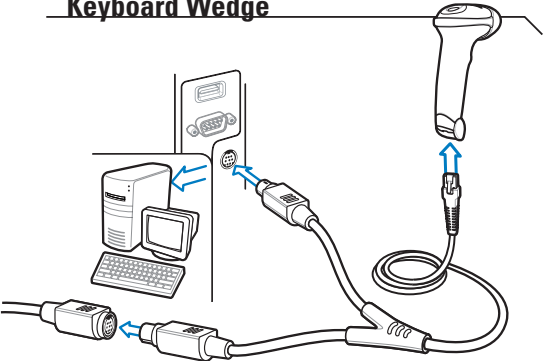

Step 3 - Scan the following



IBM PC/AT and IBM PC COMPATIBLE

Step 3 - Scan **ONE** of the following



PORT 5B



PORT 9B

Wand Emulation

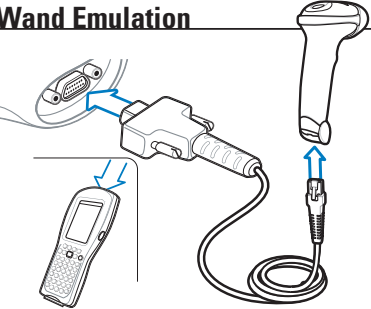

Step 3 - Scan **ONE** of the following



SYMBOL WAND



ENABLE CONVERT TO CODE 39



DISABLE CONVERT TO CODE 39

LED Indications

Off

Scanner is on and ready to scan, or no power to scanner

Green

Bar code is successfully decoded

Red

Transmission error

Beeper Indications

Standard Use

Low/medium/hih beep

Power up

Short medium beep

Bar code decoded

4 long low beeps

Transmission error detected, data is ignored

Parameter Menu Scanning

High/low/high/low beep

Successful parameter setting

High/low beep

Correct programming sequence performed

Low/High beep

Incorrect programming sequence or 'Cancel' bar code scanned

Accessories

IntelliStand

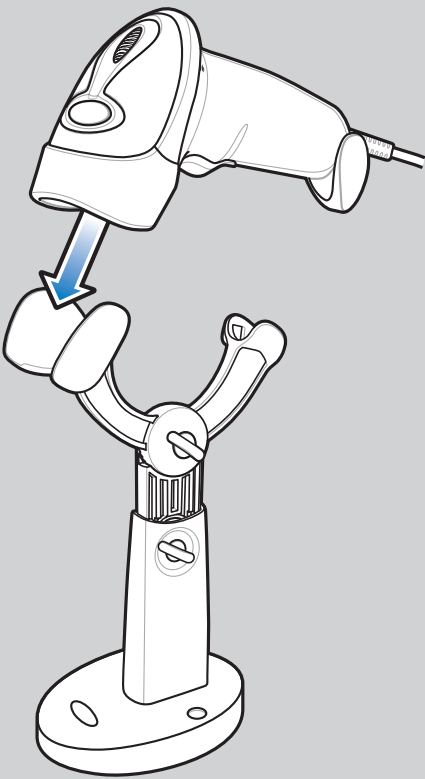

Troubleshooting

Scanner not working

No power to scanner

Check system power; ensure power supply, if required, is connected

Incorrect interface cable used

Ensure that correct interface cable is used

Interface/power cables are loose

Ensure all cable connections are secure

Scanner decoding bar code, but data not transmitting to host

Scanner not programmed for correct host interface

Scan appropriate host parameter bar codes

Interface cable is loose

Ensure all cable connections are secure

Scanned data incorrectly displayed on host

Scanner not programmed for correct host interface

Scan appropriate host parameter bar codes

Scanner not decoding bar code

Scanner not programmed for bar code type

Ensure scanner is programmed to read type of bar code being scanned

Bar code unreadable

Ensure bar code not defaced; try scanning test bar code of same bar code type

Distance between scanner and bar code incorrect

Move scanner closer to or further from bar code

OPTIMUM SCANNING POSITIONS

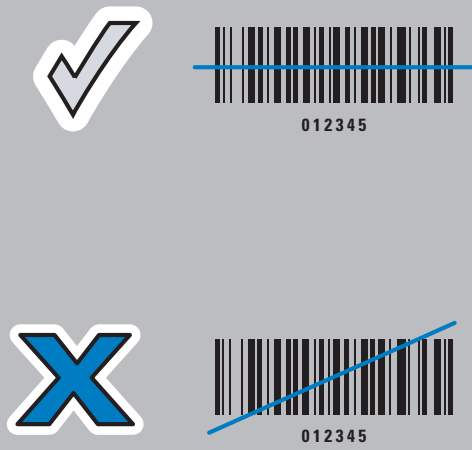
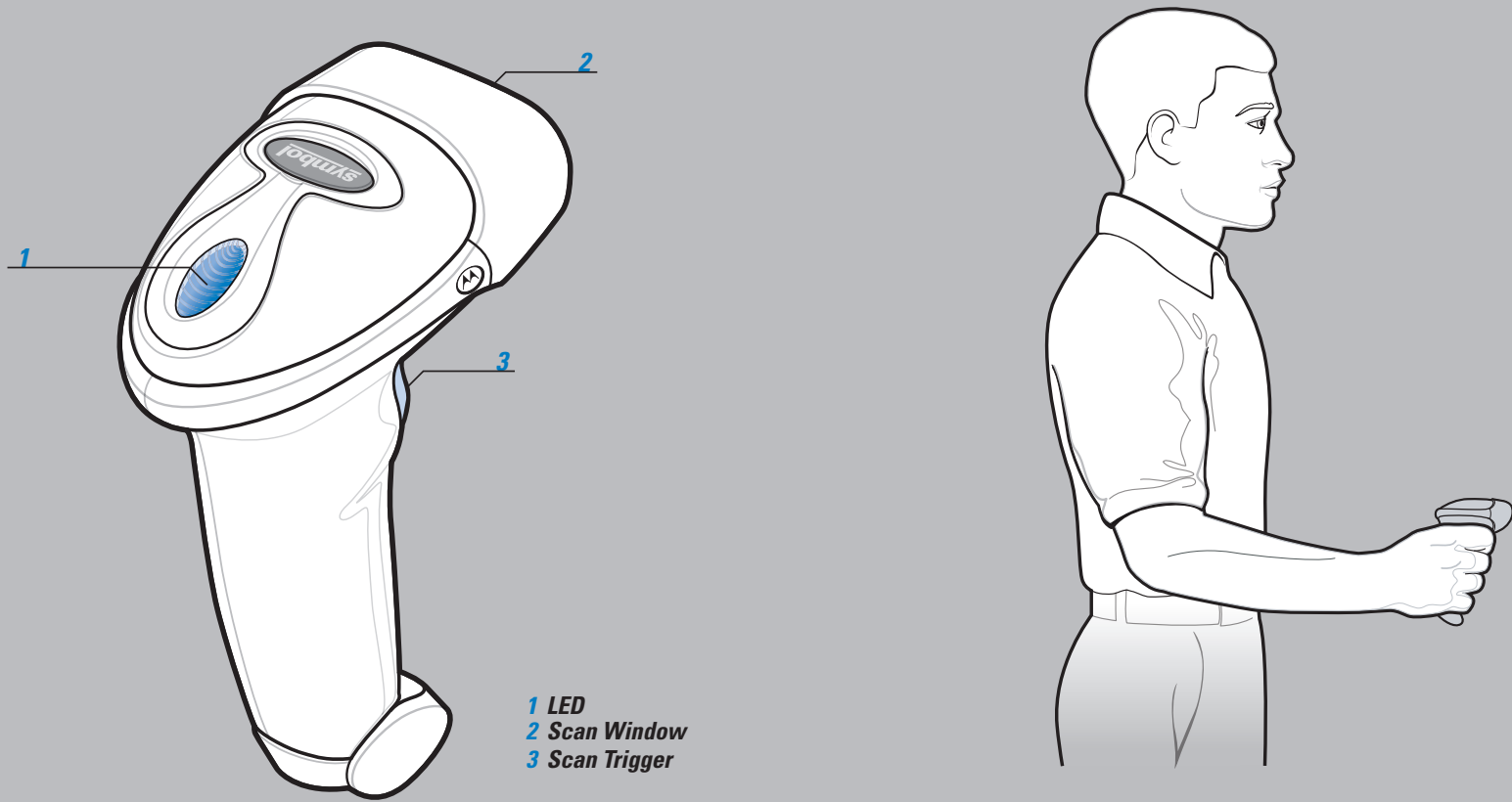

OPTIMUM UPRIGHT BODY POSTURE

Avoid Extreme Wrist Angles

Avoid Bending

Avoid Reaching

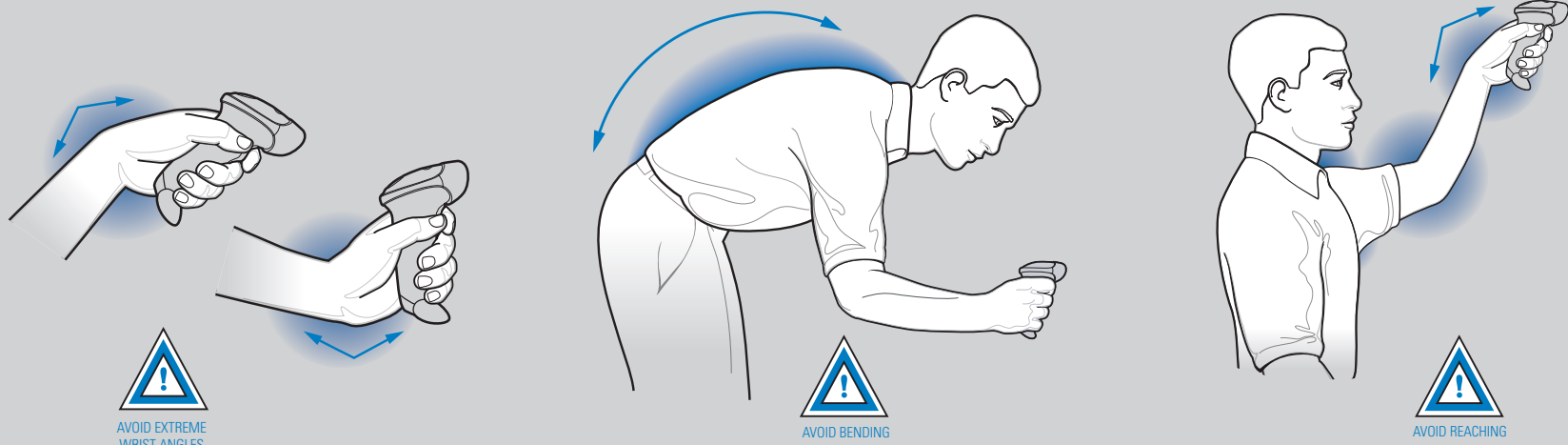

Ergonomic Recommendations

Caution: In order to avoid or minimize the potential risk of ergonomic injury follow the recommendations below. Consult with your local Health & Safety Manager to ensure that you are adhering to your company's safety programs to prevent employee injury.

- Reduce or eliminate repetitive motion
- Maintain a natural position
- Reduce or eliminate excessive force
- Keep objects that are used frequently within easy reach
- Perform tasks at correct heights
- Reduce or eliminate vibration
- Reduce or eliminate direct pressure
- Provide adjustable workstations
- Provide adequate clearance
- Provide a suitable working environment
- Improve work procedures.

REGULATORY INFORMATION

© MOTOROLA, INC. 2007 All rights reserved. Motorola reserves the right to make changes to any product to improve reliability, function, or design. Motorola does not assume any product liability arising out of, or in connection with, the application or use of any product, circuit, or application described herein. No license is granted, either expressly or by implication, estoppel, or otherwise under any patent right or patent, covering or relating to any combination, system, apparatus, machine, material, method, or process in which Motorola products might be used. An implied license exists only for equipment, circuits, and subsystems contained in Motorola products. MOTOROLA, the Stylized M Logo and Symbol and the Symbol logo are registered trademarks of Motorola, Inc. Other product names mentioned in this manual may be trademarks or registered trademarks of their respective companies and are hereby acknowledged. Motorola, Inc. One Motorola Plaza, Holtsville, N.Y. 11742-1300 • <http://www.symbol.com>

Warranty
For the complete Motorola hardware product warranty statement, go to: <http://www.symbol.com/warranty>.

Patents
This product is covered by one or more patents. For patent information go to: <http://www.symbol.com/patents>.

Service Information
If you have a problem using the equipment, contact your facility's Technical or Systems Support. If there is a problem with the equipment, they will contact the Motorola Enterprise Mobility Support at: <http://www.symbol.com/contactsupport>. For the latest version of this guide go to: <http://www.symbol.com/manuals>.

Waste Electrical and Electronic Equipment (WEEE)

English: For EU Customers: All products at the end of their life must be returned to Motorola for recycling. For information on how to return product, please go to: http://www.symbol.com/environmental_compliance.
Bulgarian: За клиентите от ЕС: След края на ползването или живота всички продукти трябва да се връщат на Motorola за рециклиране. За информация относно връщането на продукти, моля отидете на адрес: <http://www.symbol.com/weeeenl>.
Czech: Pro zákazníky z EU: Všechny produkty je nutné po skončení jejich životnosti vrátit společnosti Motorola k recyklaci. Informace o způsobu vrácení produktu najdete na webové stránce: http://www.symbol.com/environmental_compliance.
Danish: Til kunder i EU: Alle produkter skal returneres til Motorola til recykling, når de er udfjelt. Læs oplysningerne om returnering af produkter på: http://www.symbol.com/environmental_compliance.
Deutsch: Für Kunden innerhalb der EU: Alle Produkte müssen am Ende ihrer Lebensdauer zum Recycling an Motorola zurückgesandt werden. Informationen zur Rücksendung von Produkten finden Sie unter http://www.symbol.com/environmental_compliance.
Eλληνικά: Για πελάτες στην Ε.Ε.: Όλα τα προϊόντα, στο τέλος της ζωής τους, πρέπει να επιστρέφονται στην Motorola για ανακύκλωση. Για περισσότερες πληροφορίες σχετικά με την επιστροφή ενός προϊόντος, επισκεφτείτε τη διεύθυνση http://www.symbol.com/environmental_compliance.
Esdi: EU klientidele: kõik tooted tuleb nende elutsükli lõppedes tagastada taaskasutamise eesmärgil Motorola'ile. Lisainformatsiooni saamiseks toote tagastamise kohta külastage palun aadressi: http://www.symbol.com/environmental_compliance.
Español: Para clientes en la Unión Europea: todos los productos deberán entregarse a Motorola al final de su ciclo de vida para que sean reciclados. Si desea más información sobre cómo devolver un producto, visite: http://www.symbol.com/environmental_compliance.
Frangais: Clients de l'Union Européenne : Tous les produits en fin de cycle de vie doivent être retournés à Motorola pour recyclage. Pour de plus amples informations sur le retour de produits, consultez : http://www.symbol.com/environmental_compliance.
Italiano: per i clienti dell'UE: tutti i prodotti che sono giunti al termine del rispettivo ciclo di vita devono essere restituiti a Motorola al fine di consentire il riciclaggio. Per informazioni sulle modalità di restituzione, visitate il seguente sito Web: http://www.symbol.com/environmental_compliance.

MOTOROLA
Motorola, Inc. One Motorola Plaza Holtsville, New York 11742, USA
1-800-927-9626 <http://www.symbol.com>



72-71882-01
Rev B August 2007

Laser Labels



ENGLISH
CLASS 1
CLASS 2
CLASS 1 LASER PRODUCT
LASER LIGHT
DO NOT STARE INTO BEAM
CLASS 2 LASER PRODUCT

DANISH / DANSK
KLASSE 1
KLASSE 2
KLASSE 1 LASERPRODUKT
LASERLYF
SE IKKE IND I STRÅLEN
KLASSE 2 LASERPRODUKT

DUTCH / NEDERLANDS
KLASSE 1
KLASSE 2
KLASSE 1 LASERPRODUKT
LASERLICHT
NIET IN STRAAL STAREN
KLASSE 2 LASERPRODUKT

FINNISH / SUOMI
LUOKKA 1
LUOKKA 2
LASERTUOTE
LASERVALO
ÄLÄ TUJOTA SÄDETTÄ
LUOKKA 2 LASERTUOTE

FRENCH / FRANÇAIS
CLASSE 1
CLASSE 2
PRODUIT LASER DE CLASSE 1
LUMIÈRE LASER
NE PAS REGARDER LE RAYON FIXEMENT
PRODUIT LASER DE CLASSE 2

GERMAN / DEUTSCH
KLASSE 1
KLASSE 2
LASERPRODUKT DER KLASSE 1
LASERSTRAHLEN
NICHT DIREKT IN DEN LASERSTRAHL
SCHAUEN
LASERPRODUKT DER KLASSE 2

JAPANESE / 日本語
第1種
第2種
第1種レーザー製品
レーザー光線
光線を見つめないでください
2種 レーザー製品

KOREAN / 한국어
1등급
2등급
1등급 레이저 제품
레이저 광선
이 광선을 주시하지 마십시오.
2등급 레이저 광선

Portuguese: Para clientes da UE: todos os produtos no fim de vida devem ser devolvidos à Motorola para reciclagem. Para obter informações sobre como devolver o produto, visite: http://www.symbol.com/environmental_compliance.
Română: Pentru clienții din UE: Toate produsele, la sfârșitul duratei lor de funcționare, trebuie returnate la Motorola pentru reciclare. Pentru informații despre returnarea produsului, accesați: <http://www.symbol.com/weeeenl>.
Slovenščina: Prejeto za kupce iz EU: Vseke proizvode je potrebno po končani uporabi vrati podjetju Motorola za recikliranje. Informacije o načinu vračila izdelka najdete na spletni strani: http://www.symbol.com/environmental_compliance.
Swedish: För kunder inom EU: Alla produkter som uppnått sin livslängd måste returneras till Motorola för återvinning. Information om hur du returnerar produkten finns på http://www.symbol.com/environmental_compliance.

Symbol: For customers in EU: All products that have reached the end of their useful life must be returned to Motorola for recycling. For information on how to return the product, please go to: http://www.symbol.com/environmental_compliance.

<http://www.symbol.com/ls2208>

MOTOROLA and the Stylized M Logo and Symbol and the Symbol logo are registered in the U.S. Patent and Trademark Office. All other product or service names are the property of their respective owners. © Motorola, Inc. 2007

Regulatory Information

Symbol Technologies, Inc., the Enterprise Mobility business of Motorola, Inc. ("Motorola"). All Symbol devices are designed to be compliant with rules and regulations in locations they are sold and will be labeled as required.

Any changes or modifications to Symbol Technologies equipment, not expressly approved by Symbol Technologies, could void the user's authority to operate the equipment.



Laser Devices

Symbol products using lasers complies with 21CFR1040.10 and 1040.11, EN60825-1:1994+ A1:2002 +A2:2001 and IEC60825-1:1993+A1:1997+A2:2001. The laser classification is marked on one of the labels on the product.

Class 1 laser devices are not considered to be hazardous when used for their intended purpose. The following statement is required to comply with US and international regulations: **Caution: Use of controls, adjustments or performance of procedures other than those specified herein may result in hazardous laser light exposure.**

Class 2 laser scanners use a low power, visible light diode. As with any very bright light source, such as the sun, the user should avoid staring directly into the light beam. Momentary exposure to a Class 2 laser is not known to be harmful.

Radio Frequency Interference Requirements



Note: This equipment has been tested and found to comply with the limits for a Class B digital device pursuant to Part15 of the FCC rules. These limits are designed to provide reasonable protection against harmful interference in a residential installation. This equipment generates, uses and can radiate radio frequency energy and, if not installed and used in accordance with the instruction manual, may cause harmful interference to radio communications. However there is no guarantee that interference will not occur in a particular installation. If this equipment does cause harmful interference to radio or television reception, which can be determined by turning the equipment off and on, the user is encouraged to try to correct the interference by one or more of the following measures:

- Reorient or relocate the receiving antenna
- Increase the separation between the equipment and receiver
- Connect the equipment into an outlet on a circuit different from that to which the receiver is connected
- Consult the dealer or an experienced radio/TV technician for help.

Radio Frequency Interference Requirements – Canada

This Class B digital apparatus complies with Canadian ICES-003. Cet appareil numérique de la classe B est conforme à la norme NMB-003 du Canada.

Marking and European Economic Area (EEA)



Statement of Compliance

Symbol Technologies, Inc., hereby declares that this device is in compliance with all the applicable Directives, 89/336/EEC, 73/23/EEC. A Declaration of Conformity may be obtained from <http://www2.symbol.com/doc>

Recommended Usage Guide